

SITE PLAN OF PRE. NO. 86/1, P. MAZUMDAR ROAD, KOLKATA - 78, R.S. DAG NO. 4078 R.S. KHATIAN NO. 2233 & R.S. DAG NO. 4079, R.S. KHATIAN NO. 1082 UNDER MOUZA: KASBA, J.L. NO. 13, P.S. GARFA, (PREVIOUS P.S. KASBA) WITHIN K.M.C. WARD NO.106 DIST. 24 PGS (S) DEMARCATED IN RED BORDER.

AREA OF LAND 44 K, 14 CH. 23 SFT

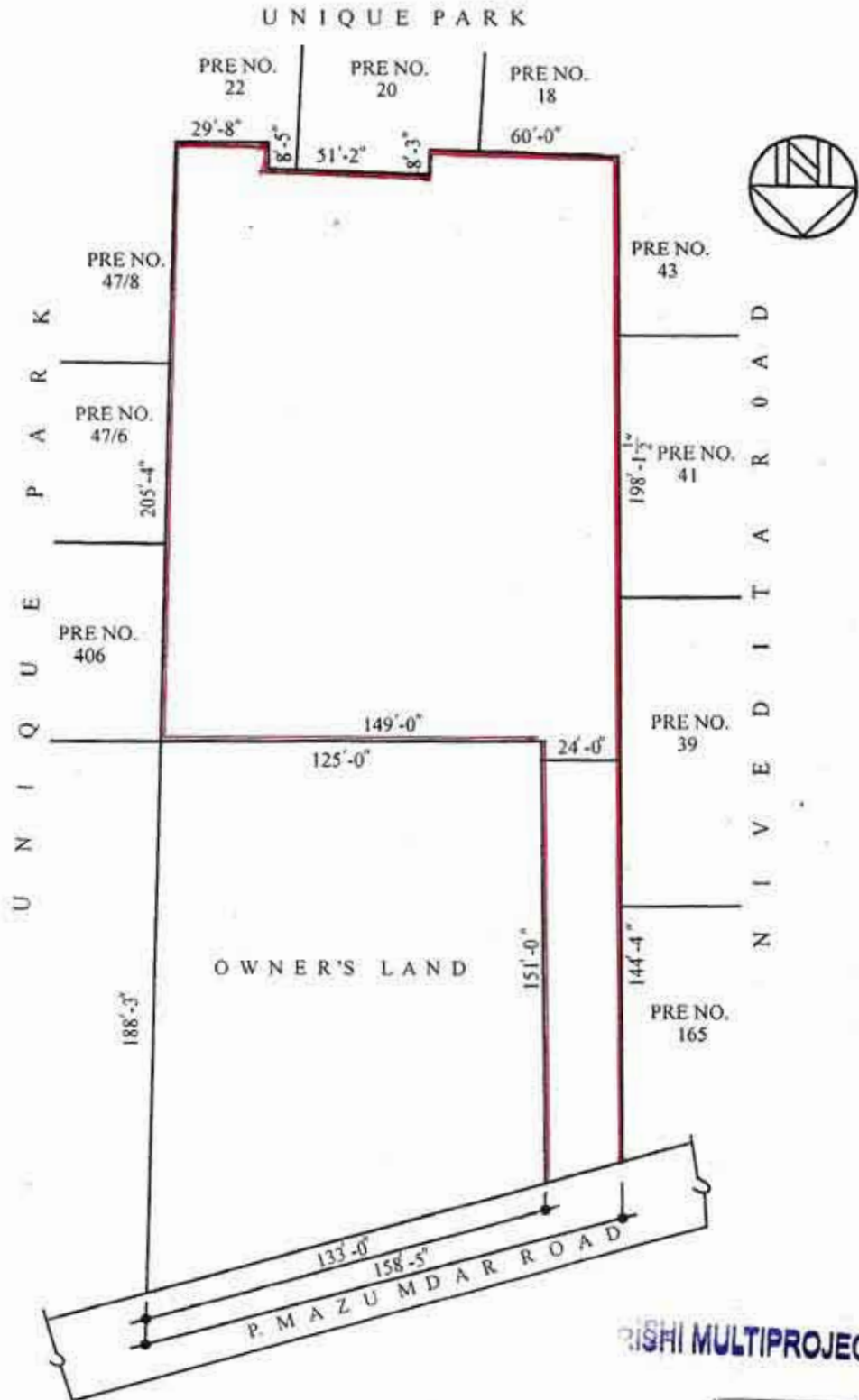

LATITUDE - 22.509581°  
 LONGITUDE - 88.394638°

RISHI MULTIPROJECTS PVT.LTD.

Director